

Design Concepts

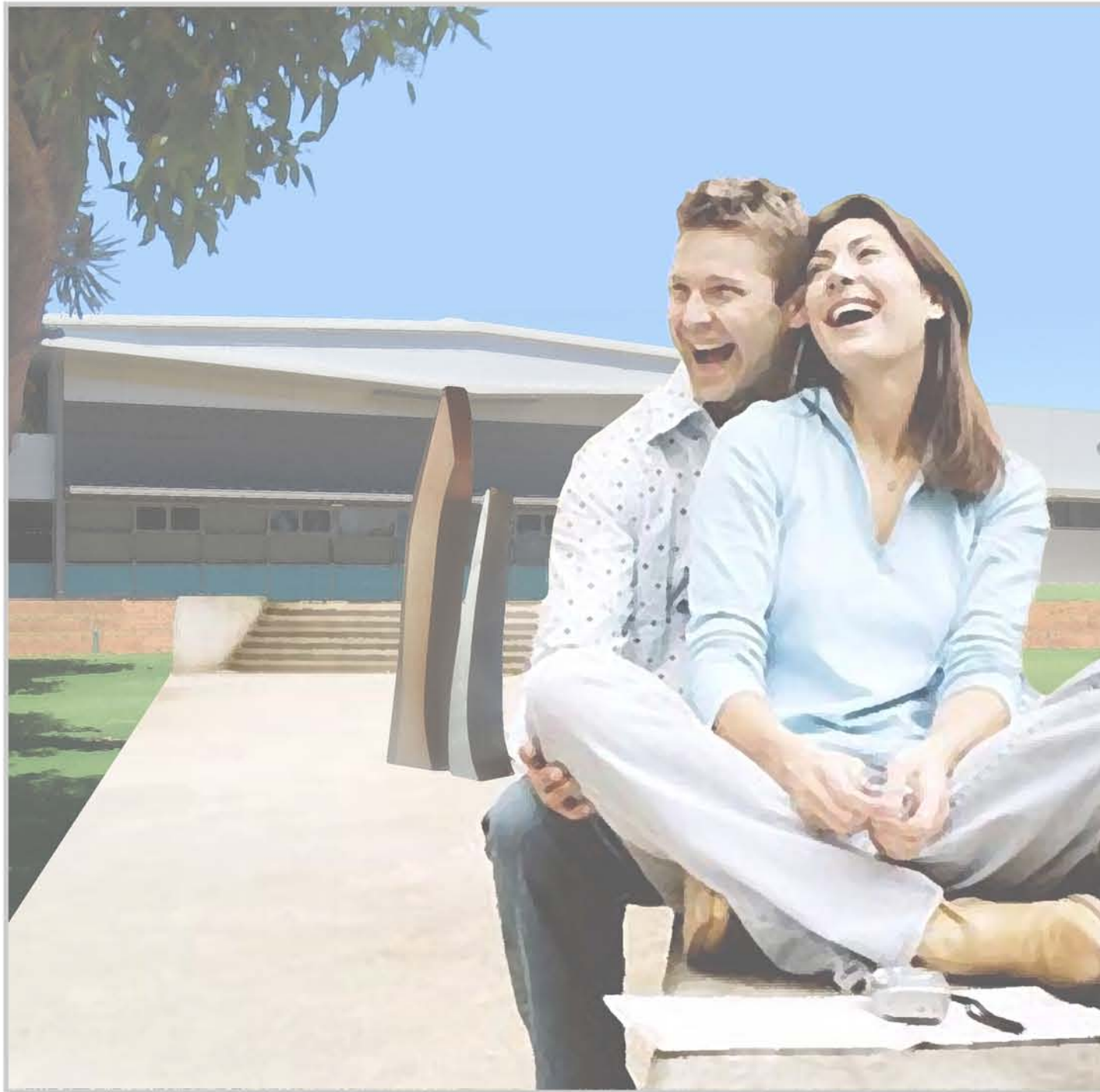

#4.

The two forms have had a big change in their relationship and dynamic. What was below has used all that stored energy to assert itself and stand tall. What was above has let go of its own striving and tension and stands to accept and acknowledge the other.

This site has been chosen as it marks an entry and exit point to the plaza and toward the TAFE. Qualities of action, decision, self-respect, equality and individuality that are embodied within this piece are also qualities found within the dynamics of human activity as they go about their business on these paths.